

# Heavier Loading - High Stability

Hydraulic Clamping on  
Auto Pallet Changer

Independent Pneumatic  
Reservoir For ATC

Hydraulic Rotating Auto Pallet Changer  
(Exchange Time: 7 ±1 Sec)

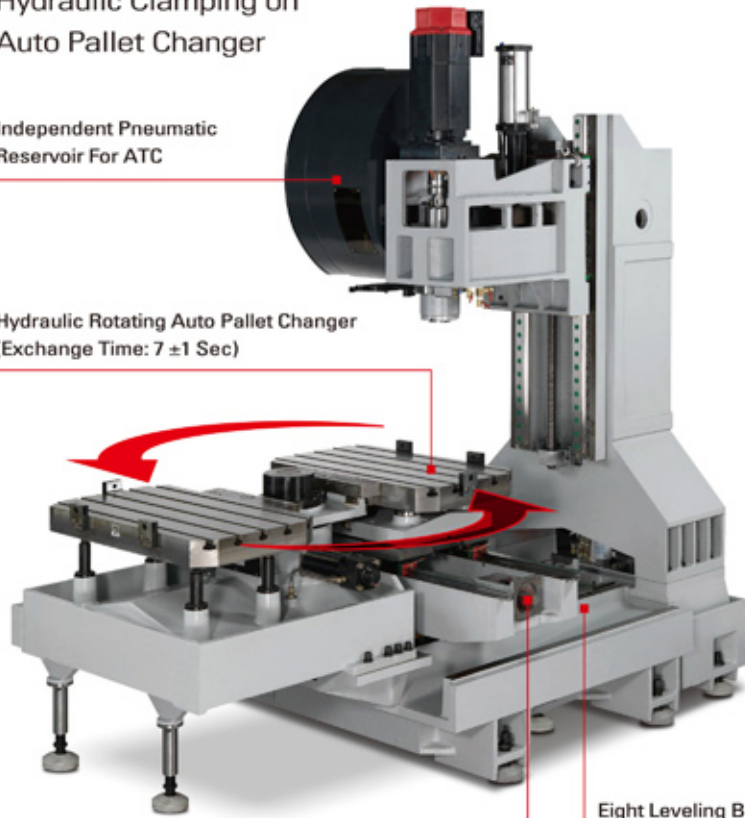

X/Y/Z Axes Roller Type  
Linear Guideways

Eight Leveling Bolts for  
High Stability Design  
(1 Close to Y Axis Track  
To Avoid Deformation)

# FOCUS SEIKI CORP.

Tel: 886-4-2529-5611

Fax: 886-4-2529-5613

<http://m.cens.com/s/focaseiki>

*A designer and maker with Europe and the Americas as main markets, Focus Seiki developed CNC vertical machining centers in 2003 and CNC horizontal machining centers in 2012. Customer-oriented as well as pursuing sustainability and growth, we achieve higher profitability year by year, being a leader in the field in Taiwan.*



CNC Vertical Machining Center  
(VMC 1600/1800/2000)

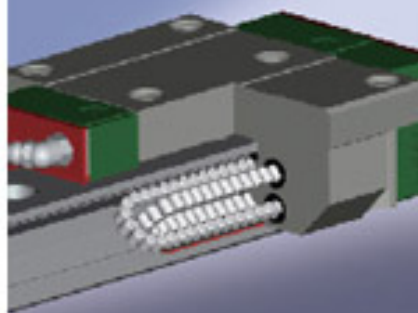

High-Rigidity Roller-Type  
Linear Guide

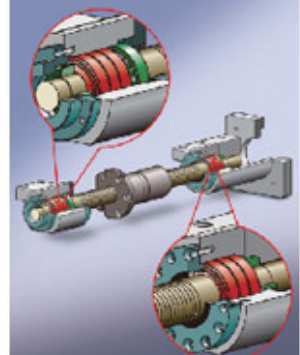

Enhanced Screw  
Pretension Design